

# C5 / CD3 Air or steam nozzles



CD3



C5

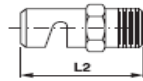
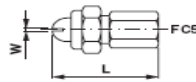
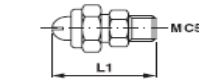

Ø	L	L1	L2 max
1/8	-	-	-
1/4	46	48	45
3/8	-	-	-

## Specification

C5 interchangeable spray tip  
 CD3 - one piece nozzle  
 C5 tip to be used with HG bodies & caps

## Materials

Brass  
 303 stainless steel

Model		W mm	Flow @ bar								Spray angle @ bar	
			Air (lpm)				Steam (kg/h)				1	4
			1	2	3	4	5	6	7	10		
1/4F-C5-1	1/4M-C5-1	0.20	21.0	38.0	65.0	101	0.70	1.40	2.20	3.60	65	85
1/4F-C5-2	1/4M-C5-2	0.33	40.0	60.0	100	152	1.50	2.00	3.50	5.50	70	80
1/4F-C5-3	1/4M-C5-3	0.58	77.0	110	190	305	2.80	4.10	6.70	11.5	80	80
1/4F-C5-4	1/4M-C5-4	1.1	131	199	345	540	4.50	7.20	12.3	19.4	70	70
1/4F-C5-5	1/4M-C5-5	1.1	210	335	570	861	7.50	12.0	20.3	32.1	80	70
1/4F-C5-6	1/4M-C5-6	2.3	430	700	1150	1724	15.5	25.0	42.0	63.0	60	70
3/8F-C5-1	3/8M-C5-1	0.20	21.0	38.0	65.0	101	0.70	1.40	2.20	3.60	65	85
3/8F-C5-2	3/8M-C5-2	0.33	40.0	60.0	100	152	1.50	2.00	3.50	5.50	70	80
3/8F-C5-3	3/8M-C5-3	0.58	77.0	110	190	305	2.80	4.10	6.70	11.5	80	80
3/8F-C5-4	3/8M-C5-4	1.1	131	199	345	540	4.50	7.20	12.3	19.4	70	70
3/8F-C5-5	3/8M-C5-5	1.1	210	335	570	881	7.50	12.0	20.3	32.1	60	70
3/8F-C5-6	3/8M-C5-6	2.3	430	700	1150	1724	15.5	25.0	42.0	63.0	60	70

Model	orifice Ømm	Flow @ bar										Spray angle	
		Air lpm					Steam (kg/h)					0.7	3.5
		0.7	1.5	2	3	3.5	0.7	1.5	2	3	3.5		
* 1/8-CD3 - 0.50	0.6	4.5	6.5	7.6	10.5	11.5	0.15	0.23	<b>0.26</b>	0.37	0.40	17	39
* 1/8-CD3 - 0.75	0.75	6.1	9.0	10.8	14.7	16.6	0.23	0.33	<b>0.39</b>	0.52	0.60	20	44
* 1/8-CD3 - 1	0.84	9.50	13.7	16.5	22.0	25.0	0.35	0.50	<b>0.59</b>	0.80	0.91	23	48
1/8-CD3 - 1.5	1.0	15.3	22.0	26.0	36.0	40.0	0.55	0.78	<b>0.95</b>	1.30	1.50	25	51
1/8-CD3 - 2	1.2	19.3	28.0	33.0	45.0	51.0	0.68	1.10	<b>1.25</b>	1.60	1.80	32	55
1/8-CD3 - 3	1.4	31.0	46.0	55.0	77.0	85.0	1.10	1.70	<b>3.00</b>	2.70	3.10	33	60
1/8-CD3 - 5	1.9	54.0	76.0	91.0	125	139	1.90	2.70	<b>3.30</b>	4.50	5.00	39	64
1/8-CD3 - 7.5	2.3	80.0	117	140	190	210	3.00	4.10	<b>5.00</b>	6.80	7.50	39	68
1/8-CD3 - 10	2.6	110	160	190	255	290	3.90	5.70	<b>6.80</b>	9.20	10.5	39	70
1/8-CD3 - 15	3.3	180	261	310	420	475	6.50	9.30	<b>11.2</b>	15.0	17.3	41	72
1/8-CD3 - 18	3.6	205	300	355	485	540	7.50	10.6	<b>12.7</b>	17.5	19.6	44	74
1/4-CD3 - 20	3.7	225	325	386	520	590	8.10	11.5	<b>13.7</b>	18.7	20.9	46	78
3/8-CD3 - 30	4.6	320	465	560	760	850	11.5	16.8	<b>20.0</b>	27.0	30.0	53	81
3/8-CD3 - 40	5.3	440	640	760	1050	1160	15.7	22.8	<b>27.0</b>	36.8	42.0	58	85

\*Material upon request