

Bio 10

Scanjet tank cleaning equipment

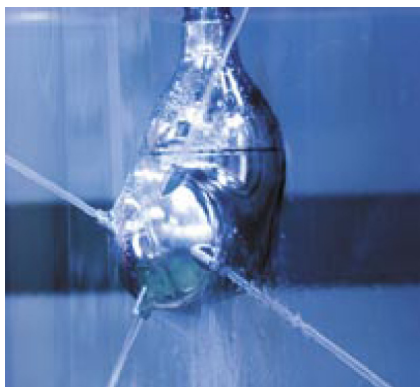

The **Bio 10** rotary jet head is a hygienic tank cleaning machine that provides 360° coverage within a given tank or process vessel. The Bio 10 is self powered by the flow of the fluid through the inlet cone of the machine. An increase in pressure and flow will correspondingly increase the length of the jet and impact upon the tank or vessel surfaces.

The Bio 10 employs exclusive self-washing features that allows itself to be completely covered and has been certified in rinse validation protocols, such as riboflavin rinse validation and yogurt trials

Quality Standards

The Bio 10 is produced in accordance to stringent quality standards and meets or exceeds ISO 9001 International Quality Standards as well as conforming to the cGMP as detailed by the United States FDA (Food and Drug Administration and EHEDG (European Hygienic Equipment design Group).

Typical Cleaning Methods

- Fixed installed CIP Systems
- Multi-Tank Solution Recovery
- Single Use/Single Pass

Typical applications for the Bio 10

- Process vessels and reactors
- Storage tanks
- Transportation tanks
- Fermenters
- Yeast propagation

KEY FEATURES

Bio 10

Bio 10 is an advanced tank cleaning machine specially developed for:

- Food & dairy
- Pharmaceutical
- Chemical Processing
- Transportation
- Beverage

Where there is a need for

- Self-washing
- Low fluid consumption
- Hygienic design

Bio 10



Bio10

TECHNICAL PERFORMANCE

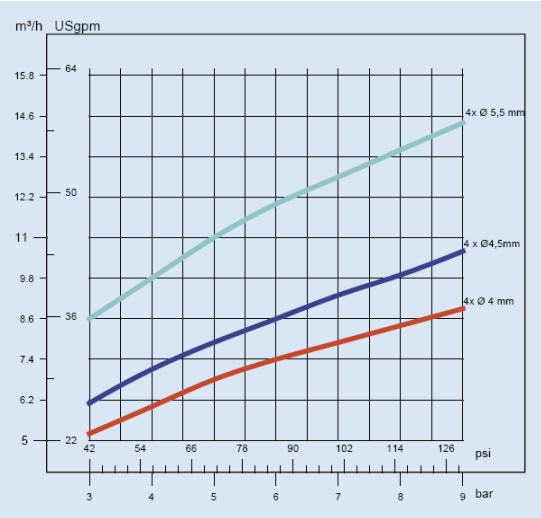

Pressure/flow

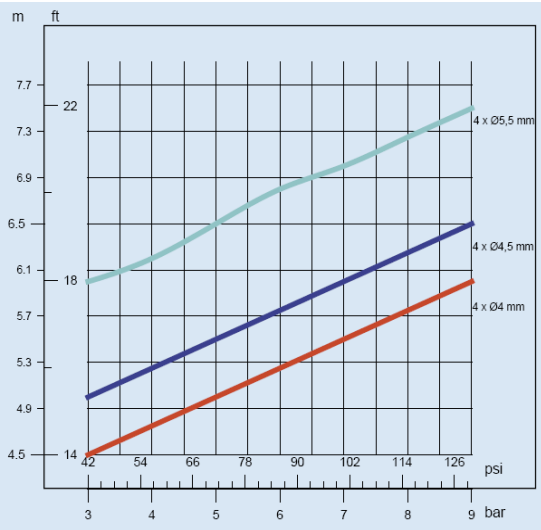

Jet length

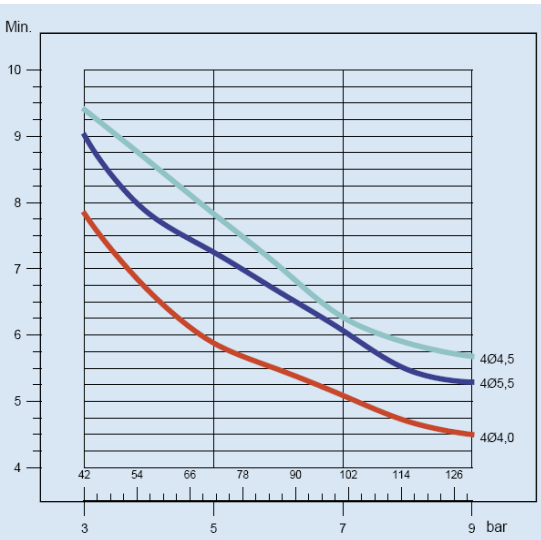

Pattern Time

DIMENSIONS

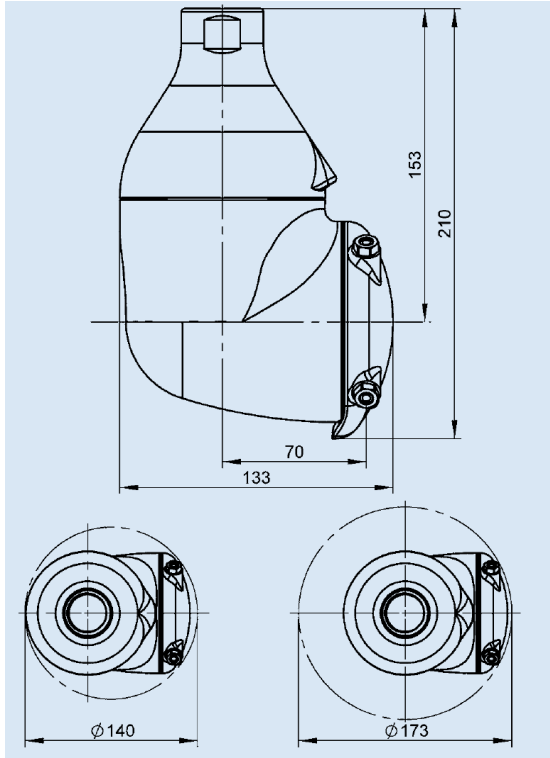

Specification

Flow		5-16m³/hr
Pressure	inlet	0-10 bar
	maximum	12 bar
	recommend	6 bar
Temperature	Max. working	95°C
	Max. ambient	140°C
Weight		5.1 kg
Connection	See model # table	
Material	AISI 316, PTFE, PEEK	
Lubrication	Cleaning media	

Standard product program model # table

Model #	Nozzles	Connection
B10-4x4.0-104	4 x 4.0mm	
B10-4x4.5-104	4 x 4.5mm	1" NPT (F)
B10-4x5.5-104	4 x 5.5mm	
B10-4x4.0-064	4 x 4.0mm	
B10-4x4.5-064	4 x 4.5mm	1" BSP(F)
B10-4x5.5-064	4 x 5.5mm	
B10-4x4.0-824	4 x 4.0mm	
B10-4x4.5-824	4 x 4.5mm	1" Clip on
B10-4x5.5-824	4 x 5.5mm	
B10-4x4.0-844	4 x 4.0mm	
B10-4x4.5-844	4 x 4.5mm	1" Weld
B10-4x5.5-844	4 x 5.5mm	
B10-4x4.0-846	4 x 4.0mm	
B10-4x4.5-846	4 x 4.5mm	1.5" Weld
B10-4x5.5-846	4 x 5.5mm	